

## Articulating Support Arms

The basic underlying reason for the use of an articulating arm is to improve productivity through applied ergonomics. A manufacturer cannot ignore the pressure to improve productivity of employees because of the impact productivity has on the bottom line.

Automated Systems offers an articulating arm that can be designed for your suspension application. Articulating arms are also called tool balance arms. Automated Systems' HDA series articulating arms are sized and designed to accommodate different size tools and mounting brackets required for specific applications. The arm can be suspended from an overhead rail,

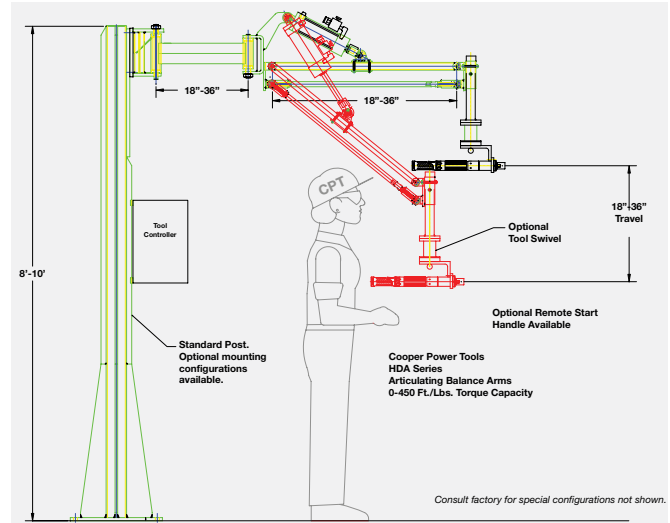

structural column, ceiling mounted or post. The tool is typically mounted on the end of the arm.

### Uses for Articulating Arms

- Stop or AGV stations
- Slow moving conveyor arms
- Work cells
- Side or overhead tool position work

### Typical Articulating Arm Features

- Single or parallel arms
- Arm leveling base
- Boom
- Air balancing cylinder
- Mounting end
- Lift arm

### Optional Features

- Pneumatic or electric disc brake

## Cable Management

Cooper Tools can provide you with assistance ranging from concept to installation of an efficient cable management solution. Cooper Tools equipment uses cables in conjunction with hand held tools, fixtured hand tools or when nutrunners are provided for incorporation into automated systems.

Cables need to be protected throughout their routing. We protect the cables from machine movement, equipment, chaffing, sharp objects, vibration, heat and liquid.

We have a full support staff of Sales Engineers, Mechanical Engineers, Controls Engineers, Project Managers, Field Service Engineers and In-house Service Engineers waiting to serve you.

