

Flush Socket Nutrunners

Clecomatic Clutch & Stall

Cleco®

34 Series

Torque Range

5 - 103 Nm 4 - 76 Ft. Lbs.

- External torque adjustment (Clecomatic models)
- Indexable anglehead
- One torque spring to meet specified range
- Oilless blades 
- Reversible

X Dimension For Flush Socket

Head	Inches	Milimeters	Socket Size Range
F1	1.54	39	8-15mm
F2	1.69	43	10-15mm
F3	2.32	59	13-21mm

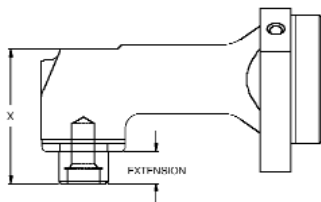

NOTE: Models listed are examples. Use chart on bottom of facing page for specific model required but not listed.



Model Number	Socket Size	Free Speed RPM	Torque		Length		Weight		Anglehead			
			ft.-lbs.	Nm	in.	mm	lbs.	kg	Height		Side to Center	
									in.	mm	in.	mm
Clecomatic - Lever Start - Reversible												
34RAA09F1MD00	10 mm	1825	4-7	5-9	17.0	432	3.7	1.7	1.54	39	0.55	14
34RAA16F1MD00	10 mm	1055	7-12	9-16	17.0	432	3.7	1.7	1.54	39	0.55	14
34RAA28F1MG00	13 mm	645	10-20*	14-28*	17.8	452	3.9	1.8	1.54	39	0.55	14
34RAA33F2MG00	13 mm	540	12-24	17-33	18.8	478	4.7	2.1	1.69	43	0.67	17
34RAA47F2MG00	13 mm	380	17-35	24-47	19.0	483	5.1	2.3	1.69	43	0.67	17
34RAA53F2MI00	15 mm	265	17-39	24-53	19.0	483	5.1	2.3	1.69	43	0.67	17
34RAA67F3MI00	15 mm	265	24-49	33-67	20.5	521	5.8	2.6	2.32	59	0.87	22
34RAA94F3ML00	18 mm	185	35-69	47-94	20.5	521	5.8	2.6	2.32	59	0.87	22
Stall - Lever Start - Reversible												
34RAS10F1MD00	10 mm	1825	7	10	17.0	432	3.4	1.5	1.54	39	0.55	14
34RAS18F1MD00	10 mm	1055	13	18	17.0	432	3.4	1.5	1.54	39	0.55	14
34RAS30F1MG00	13 mm	645	22*	30*	17.8	452	3.5	1.6	1.54	39	0.55	14
34RAS40F2MG00	13 mm	480	29	40	19.0	483	4.4	2.0	1.69	43	0.67	17
34RAS52F2MI00	15 mm	380	38	52	19.0	483	4.4	2.0	1.69	43	0.67	17
34RAS58F3MI00	15 mm	335	43	58	20.5	521	5.5	2.5	2.32	59	0.87	22
34RAS73F3MI00	15 mm	265	54	73	20.5	521	5.5	2.5	2.32	59	0.87	22
34RAS103F3ML00	18 mm	185	76	103	20.5	521	5.5	2.5	2.32	59	0.87	22

* Maximum torque of tool exceeds the maximum torque rating for the head, high maintenance should be expected when operated at the upper torque capacity range.

GENERAL:

Air Inlet: 3/8" NPT
 Minimum Hose Size: 5/16"
 Tool performance rated at 90 psi (620kPa) air pressure.

STANDARD EQUIPMENT:

Operating instructions & service manual
 Suspension bail
 Exhaust Overhose
 Clutch adjustment tool (Clecomatic tools)
 Mounting plate (F3 tools)

OPTIONAL EQUIPMENT:

Assembly wrench: 201898

Torque signal kit: 201900

Non-reversible kit: 204999

Mounting plates: F1 tools

57217101

57218103

F2 tools

43287131

Additional accessories: Page 57