

# Hook Mounted Hoists

**GARDNER-DENVER®**

**K5 Series**

Capacity:  
550-2200 lbs.  
250-1000 kg

- Rotary Vane Air Motor
- Rope or Pendant Control
- Link or Roller Chain



**Single Reeved**  
550 lbs. (250 kg) & 1100 lbs. (500 kg) Capacity

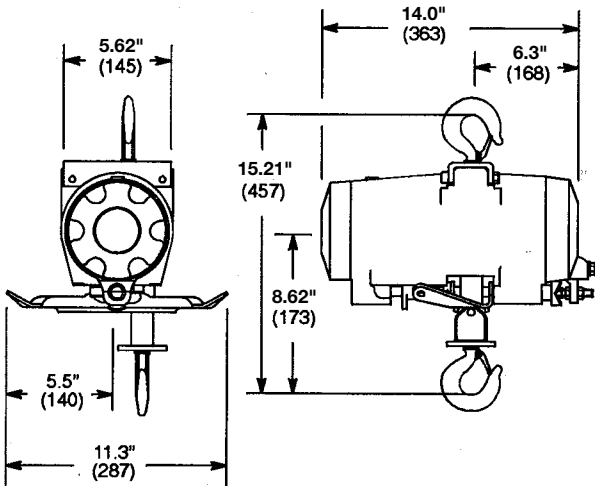

**Double Reeved**  
2200 lbs. (1000 kg) Capacity

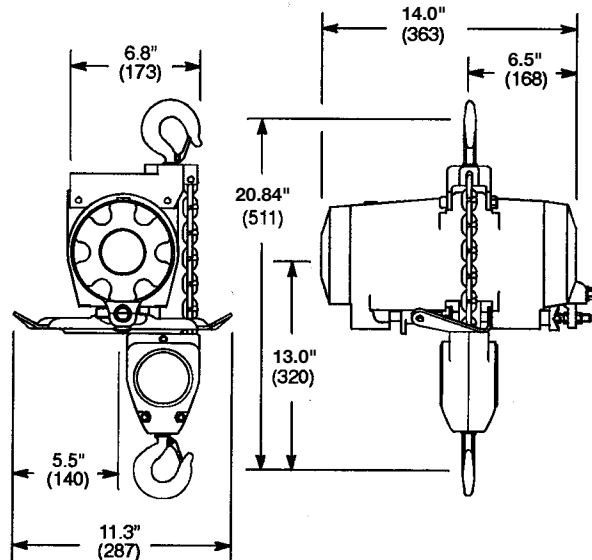

# Hook Mounted Hoists

**K5 H A 05 L P E L --- A A A 05**

**SERIES**

**K5**

**TYPE MOUNT**

**H = Hook**

**FEATURES**

**A = Standard Unit**  
**H = Hi Temp Grease**  
**P = Epoxy Paint**  
**S = Epoxy Paint/Hi Temp Grease**

**CAPACITY**

**05 = 550 lbs.**  
**11 = 1100 lbs.**  
**22 = 2200 lbs.**

**CHAIN TYPE**

**L = Link**  
**R = Roller**

**CONTROL TYPE**

**P = Pendent (Standard-2LVR)**  
**R = Rope**  
**W = None-Pendent Ready**  
**X = None**

**CONTROL LENGTH**

**E = 5 FT**      **T = 20 FT**  
**J = 10 FT**     **Y = 25 FT**  
**O = 15 FT**     **Z = None**

**CHAIN OPTIONS**

**L = Standard Link**  
**P = Zinc Plated Link**  
**R = Standard Roller**  
**X = No Chain**

**CAPACITY RATING**

**05 = 550 lbs. (05)**  
**06 = 550 lbs. (22)**  
**11 = 1100 lbs. (11)**  
**12 = 1100 lbs. (22)**  
**22 = 2200 lbs. (22)**

**VINTAGE**

**A**

**LOWER HOOK**

**A = Standard Link (05/11)**  
**B = Bullard Link (05/11)**  
**C = Standard Roller (05/11)**  
**D = Bullard Roller (05/11)**  
**E = Standard Link (22)**  
**F = Bullard Link (22)**  
**G = Standard Roller (22)**  
**H = Bullard Roller (22)**  
**X = No Hook**

**UPPER HOOK**

**A = Standard (05/11)**  
**B = Bullard (05/11)**  
**C = Standard (22)**  
**D = Bullard (22)**  
**X = No Hook**

**AMOUNT OF LIFT**

--- Specify Length in Feet, 3 digits

Example: 10' lift\_010

Note: Numbers in parentheses following an option, represent the hoist capacities for which that option is available.

Model Number		Chain Type	Capacity		Lifting & Lowering Speeds				Reeves	Weight	
Pendent Control	Rope Control				Lifting		Lowering				
			lbs.	kg	fpm	mpm	fpm	mpm	lbs.	kg	
K5HA05LPEL010AAA05	K5HA05LREL010AAA05	Link	550	250	40-67	12-20	110-147	33-44	1	42	19
K5HA05RPER010ACA05	K5HA05RRER010ACA05	Roller	550	250	40-67	12-20	110-147	33-44	1	42	19
K5HA11LPEL010AAA11	K5HA11LREL010AAA11	Link	1100	500	20-50	6-15	80-120	24-36	1	42	19
K5HA11RPER010ACA11	K5HA11RRER010ACA11	Roller	1100	500	20-50	6-15	80-120	24-36	1	42	19
K5HA22LPEL010CEA22	K5HA22LREL010CEA22	Link	2200	1000	10-25	3-7	40-60	12-18	2	54	25
K5HA22RPER010CGA22	K5HA22RRER010CGA22	Roller	2200	1000	10-25	3-7	40-60	12-18	2	54	25

**GENERAL:**

Air Inlet: 1/2" NPT (use 3/4" I.D. Hose)  
 Performance rated at 90 psig (6.2 bar/620 kPa) air pressure.  
 Air Consumption 75 cfm (2.12m³/min.) at rated load.

**STANDARD EQUIPMENT:**

Hook mounted air hoist with 10 ft. (3.0m) lift  
 Rope Control: 5 ft. (1.5m) rope length  
 Pendent Control: 5 ft. (1.5m) hose length

**EXTRA EQUIPMENT:**

Chain container – page 52-53  
 Hoist trolleys – page 20  
 Auxiliary cable (Backup suspension) – page 55  
 Air strainer intake fitting – A10161  
 Piped exhaust adapter (3/4"NPT) – 536567