

# Hoist/Hoisttractor Combination Units

## GARDNER-DENVER®

### P2 Series

Capacity:  
1100-4400 lbs.  
500-2000 kg

Beam flange width:  
3.00-5.25 in  
76-133 mm

Minimum turning radius:  
1100 lbs., 1500 lbs., 2200 lbs. cap.  
26 in  
660 mm

3000 lbs., 4000 lbs. cap.  
42 in  
1067 mm

- Axial Piston Air Motor
- Pendant Control
- Link Chain



**Single Reeved**  
1100 lbs. (500 kg), 1500 lbs. (680 kg) &  
2200 lbs. (1000 kg) Capacity

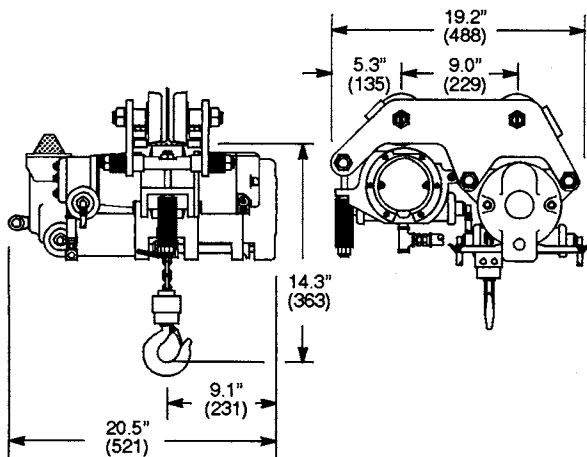

**Double Reeved**  
3000 lbs. (1360 kg) & 4400 lbs. (2000 kg) Capacity

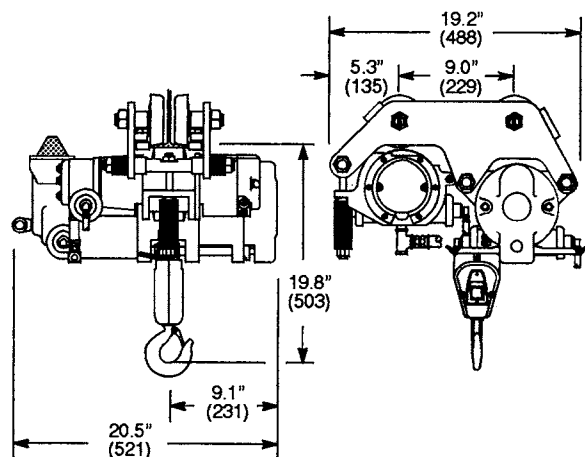

# Hoist/Hoistactor Combination Units

**P2 C A 11 L P E L --- A A A 11**

**SERIES**

P2

**TYPE MOUNT**

C = Combination

**FEATURES**

A = Standard Unit  
 E = Edible Grease  
 H = Hi Temp Grease  
 P = Epoxy Paint  
 R = Epoxy Paint/Edible Grease  
 S = Epoxy Paint/Hi Temp Grease

**CAPACITY**

10 = 1000 lbs.      22 = 2200 lbs.  
 11 = 1100 lbs.      30 = 3000 lbs.  
 15 = 1500 lbs.      44 = 4400 lbs.

**CHAIN TYPE**

L = Link

**CONTROL TYPE**

P = Pendent (w/Hoistactor-4LVR)  
 W = None-Pendent Ready

**CONTROL LENGTH**

E = 5 FT      T = 20 FT  
 J = 10 FT      Y = 25 FT  
 O = 15 FT      Z = No Control Length

**CHAIN OPTIONS**

L = Standard Link  
 P = Zinc Plated Link  
 Q = S.R. Link  
 X = No Chain

**AMOUNT OF LIFT**

--- Specify Length in Feet, 3 digits  
 Example: 10' Lift 010

Note: Numbers in parentheses following an option, represent the hoist capacities for which that option is available.

**CAPACITY RATING**

03 = 300 lbs. (10/11/15)  
 05 = 500 lbs. (10/11/15)  
 10 = 1000 lbs. (10/11/15)  
 11 = 1100 lbs. (10/11/15)  
 15 = 1500 lbs. (15/22)  
 20 = 2000 lbs. (22)  
 22 = 2200 lbs. (22)  
 30 = 3000 lbs. (30/44)  
 31 = 1100 lbs. (30)  
 32 = 2200 lbs. (30/44)  
 40 = 4000 lbs. (44)  
 44 = 4400 lbs. (44)

**VINTAGE**

A

**LOWER HOOK**

A = Standard (11/22)      F = S.R. Bullard (30)  
 B = Bullard (11/22)      G = Standard (44)  
 C = S.R. Std. (10/15)      H = Bullard (44)  
 D = S.R. Bullard (10/15)      X = No Hook  
 E = S.R. Std. (30)

**TRACTOR/TROLLEY**

A = 3-5.25" Std. Speed Tapered (11/22/44)  
 B = 3-5.25" Std. Speed Flat (11/22/44)  
 C = 3-5.25" Std. Speed S.R. Tapered (10/15/30)  
 D = 3-5.25" Std. Speed S.R. Flat (10/15/30)  
 E = 3-5.25" Slow Speed Tapered (11/22/44)  
 F = 3-5.25" Slow Speed Flat (11/22/44)  
 G = 3-5.25" Slow Speed S.R. Tapered (10/15/30)  
 H = 3-5.25" Slow Speed S.R. Flat (10/15/30)  
 I = 3-5.25" High Speed Tapered (11/22/44)  
 J = 3-5.25" High Speed Flat (11/22/44)  
 K = 3-5.25" High Speed S.R. Tapered (10/15/30)  
 L = 3-5.25" High Speed S.R. Flat (10/15/30)  
 M = 5-7" Std. Speed Tapered (11/22/44)  
 N = 5-7" Std. Speed Flat (11/22/44)  
 O = 5-7" Std. Speed S.R. Tapered (10/15/30)  
 P = 5-7" Std. Speed S.R. Flat (10/15/30)  
 Q = 5-7" Slow Speed Tapered (11/22/44)  
 R = 5-7" Slow Speed Flat (11/22/44)  
 S = 5-7" Slow Speed S.R. Tapered (10/15/30)  
 T = 5-7" Slow Speed S.R. Flat (10/15/30)  
 U = 5-7" High Speed Tapered (11/22/44)  
 V = 5-7" High Speed Flat (11/22/44)  
 W = 5-7" High Speed S.R. Tapered (10/15/30)  
 Y = 5-7" High Speed S.R. Flat (10/15/30)

Model Number	Chain Type	Capacity		Lifting & Lowering Speeds				Traversing Speed		Reeves	Weight	
		lbs.	kg	Maximum Lift		Maximum Lower		fpm	mpm		lbs.	kg
P2CA11LPEL010AAA11	Link	1100	500	34	10	107	33	70	21	1	145	66
P2CA22LPEL010AAA22	Link	2200	1000	17	5	56	17	69	21	1	170	77
P2CA44LPEL010AGA44	Link	4400	2000	9	3	28	9	65	20	2	202	92
<b>Spark Resistant Units</b>												
P2CA15LPEQ10CCA15	Link	1500	680	23	7	58	18	70	21	1	170	77
P2CA30LPEQ10CEA30	Link	3000	1360	11	3	26	8	65	20	2	202	92

**GENERAL:**

Air Inlet: 3/8" NPT (use 5/8" I.D. Hose)  
 Performance rated at 90 psig (6 bar/620 kPa) air pressure.  
 Air Consumption:  
 Hoist – 44 cfm (1.2 m³/min.) at rated load.  
 Hoistactor – 30 cfm (.8 m³/min) at rated load.

**STANDARD EQUIPMENT:**

Hoist/Hoistactor combination unit with 10 ft. (3.0m) lift  
 Pendent Control: 5 ft. (1.5m) hose length

**EXTRA EQUIPMENT:**

Chain container – page 53  
 Additional Pendent Control hose lengths (specify when ordering)  
 Piped exhaust adapter (1/2 " NPT) – 500344  
 (3/4" NPT) – 535779