

# Airetool Boiler Tube Cleaners

## Tube Cleaners for Straight Tubes

Complete series of motors and heads available for tube sizes  
1/2" to 1-3/8" (12.7 to 34.9 mm) I.D.



MIDGET MOTOR  
WITH OPTIONAL HEADS

Complete cleaner consists of: air motor with extra set of blades; metal box; choice of single unit cutter head with four extra sets of cutters and two extra cutter pins. If "30" series head shown on page 78 is ordered, one extra flexible connection is furnished.

If expanding blade head is ordered, one extra set of blades is furnished. For operating hose (not included) refer to page 99.



Drill Head with Universal Joint  
Range: 1/2 in. (12.7 mm) - 1-3/8 in. (34.9 mm)  
Deposit: heavy-medium to soft



Single Unit Head with Universal Joint  
Range: 1/2 in. (12.7 mm) - 1-3/8 in. (34.9 mm)  
Deposit: light-hard to medium



Expanding Blade Cutter Head  
Range: 1/2 in. (12.7 mm) - 4-1/2 in. (114.3 mm)  
Deposit: light-hard to medium

Complete series of motors and heads available for tube sizes  
1-1/2" to 13-1/4" (38.1 to 336.5 mm) I.D.

Drill Head with Universal Joint  
Range: 1-1/2 in. (38.1 mm) -  
11 in. (279.4 mm)  
Deposit: 3/4 in. (19.0 mm)  
thick-medium to hard and  
plugged tubes



TYPE-3  
P-Type Head  
Range: 2-1/4 in. (57.1 mm) -  
7 in. (177.8 mm) Self feeding  
Deposit: 3/8 in. (9.5 mm)  
thick-hard to medium



TYPE-5  
Wing Arm Head  
Range: 1-3/4 in. (44.4 mm) -  
13 1/4 in. (336.5 mm)  
Self feeding  
Deposit: 1/2 in. (12.7 mm)  
thick-hard to medium



TYPE-4  
Forward Swing Head  
Range: 1-3/4 in. (44.4 mm) -  
4 1/4 in. (120.6 mm)  
Self feeding  
Deposit: 1/2 in. (12.7 mm)  
thick-soft to medium

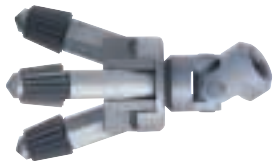

3000 SERIES MOTOR  
WITH OPTIONAL HEADS

Complete cleaner consists of: air motor with extra set of blades; choice of cutter head with two extra sets of cutters and cutter pins; universal joint with two extra pins; two drills.

If single unit head is ordered, four extra sets of cutters are furnished. If arm-type heads are ordered, one extra set of arm pins is furnished. For operating hose (not included) refer to page 99.