

- Torque Range
5.3 - 29.2 In. Lbs.
0.6 - 3.3 Nm
- Immediate, automatic air shut-off guarantees high torque repeatability and reduces quality controls at the end of the assembly process.
- The cycle end acoustic signal permits the operator to pass on to the next tightening cycle more rapidly.
- Reverse button with a locking system
- 1/4" Hex quick change chuck
- Extremely light and easy to handle for operator comfort & productivity
- Designed for use with either lubricated or unlubricated compressed air



FASTENING

Model Number	Screw Size		Max. Free RPM	Torque Rating				Length		Weight	
	in	mm		Hard Joint		Soft Joint		in.	mm	lbs.	kg
				In. Lbs.	Nm	In. Lbs.	Nm				
Inline, Push-to-Start, Auto Shutoff											
MP2603B	#8	3.5	1300	5.3-21.2	0.6-2.4	5.3-21.2	0.6-2.4	8.7	218	1.2	0.56
Pistol Grip, Trigger Start, Auto Shutoff											
MP2652B	#10	4	900	5.3-29.2	0.6-3.3	5.3-29.2	0.6-3.3	7.9	200	1.7	0.75

GENERAL:
Air Inlet 1/4" NPT
Use 5/16" (8 mm) I.D. hose
All tools performance rated @ 90 psi (620 kPa) air pressure

STANDARD EQUIPMENT:
Clutch Adjustment Tool
Suspension Bail
Use and Maintenance Manual

OPTIONAL EQUIPMENT:
See page 39 for optional Torque Springs.

WARNING: Face & eye protection must be worn while operating power tools, per ANSI B186.1. Cutting tool maximum speed rating must be equal or exceed speed of air tool @ 90 psi (620 kPa). Follow cutting tool manufacturer's mounting & operating instructions.



It is the user's responsibility to refer and comply with ANSI B7.1

PrecisionMaster® Nutrunners

90°

- Torque Range
120 - 208 In. Lbs.
14 - 23 Nm
- Indispensable when space is limited or where access is difficult
- Immediate and automatic air shut-off which considerably improves the repeatability of torque on all types of joints and reduces stress on the operator's hand
- End of cycle buzzer warns the operator that the tightening process is over
- Robust angle heads to guarantee long life
- Reversible, easy-to-use reverse button with locking device
- Designed for use with either lubricated or unlubricated compressed air
- Low noise and vibration levels



FASTENING

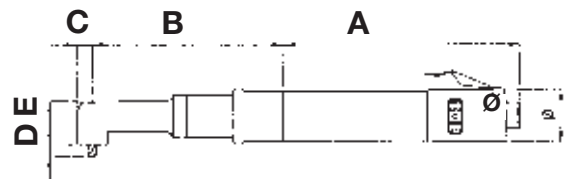

Model	A	B	C	D	E	Ø
MP2639B	180mm 7.09 in.	137mm 5.39 in.	14mm 0.55 in.	12mm 0.47 in.	34.5mm 1.36 in.	40mm 1.58 in.

Model Number	Screw Size		Max. Free RPM	Torque Rating				Length		Weight	
	in	mm		Hard Joint		SoftJoint		in.	mm	lbs.	kg
				In. Lbs.	Nm	In. Lbs.	Nm				
MP2639B	5/16"	8	350	120-208	14-23	129-230	15-26	13.0	331	3.1	1.4

GENERAL:
Air inlet 1/4" NPT
Use 5/16" (8 mm) I.D. hose
All tools performance rated @ 90psi (620 kPa) air pressure.

STANDARD EQUIPMENT
Clutch Adjustment Tool
Suspension Bail
Use and Maintenance Manual

See page 39 for optional Torque Springs.

