



# Sockets Quotation Worksheet

For quotation only. Not an order.



NAME _____	TITLE _____		
COMPANY _____			
ADDRESS _____	CITY _____	STATE _____	ZIP _____
E-MAIL _____	PHONE _____	FAX _____	

## Socket Type

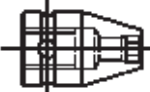

Type A (tapered)

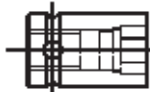

Type B (straight)

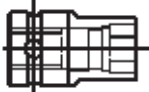

Type C (shouldered)

## Broach Opening

<input type="checkbox"/> Hex	<input type="checkbox"/> Double Square	<input type="checkbox"/> Torx®
<input type="checkbox"/> Double Hex	<input type="checkbox"/> Fast Lead	<input type="checkbox"/> Other
<input type="checkbox"/> Square	<input type="checkbox"/> Surface Drive	

## Magnetic

Magnetic Bolt Clearance (MB)  
 Magnetic Bolt Clearance, with retaining ring (RMB)  
 Strip Magnet (SM)  
 Fixed Magnet (M)  
 Non-magnetic

## Drive Configuration

DIN Standard  
 No DIN groove  
 Cross Hole (one wall only)

## Extensions

Hex Drive \_\_\_\_\_  
 Female Square \_\_\_\_\_  
 Other \_\_\_\_\_

## Size

## Extension Length

No extension required

Quantity \_\_\_\_\_

Applied or Driving Torque \_\_\_\_\_

## Nylon Covers Requirements:

### Components To Be Covered

Socket only  
 Socket and Extension

### Additional Specifications \_\_\_\_\_

\_\_\_\_\_

\_\_\_\_\_

\_\_\_\_\_

### Cover Features

Exposed tip of socket hex  
 Recessed tip of socket hex  
 Flush tip of socket hex  
 Press fit  
 Free-spinning (able to spin independently of part being covered)  
 O.D. limitations (must specify) \_\_\_\_\_  
 Other considerations (must specify) \_\_\_\_\_

### Dimensions

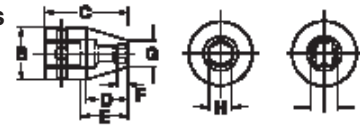

A. Square drive \_\_\_\_\_

B. Drive end diameter \_\_\_\_\_

C. Overall length \_\_\_\_\_

D. Taper or shoulder length \_\_\_\_\_

E. Bolt clearance depth \_\_\_\_\_

F. Broach depth \_\_\_\_\_

G. Nose end diameter \_\_\_\_\_

H. Broach opening \_\_\_\_\_

I. Torx® size  \_\_\_\_\_

# Universal Wrench Quotation Worksheet

For quotation only. Not an order.

Name \_\_\_\_\_ Title \_\_\_\_\_

Company \_\_\_\_\_

Address \_\_\_\_\_

Phone \_\_\_\_\_ FAX \_\_\_\_\_

## DIMENSIONS

Female square drive, standard type

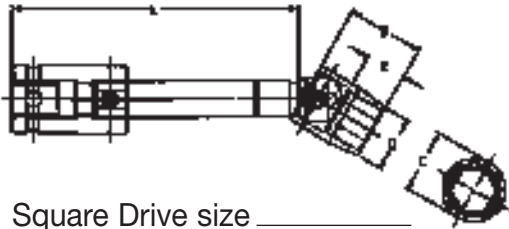

Square Drive size \_\_\_\_\_

Female square drive, tension type

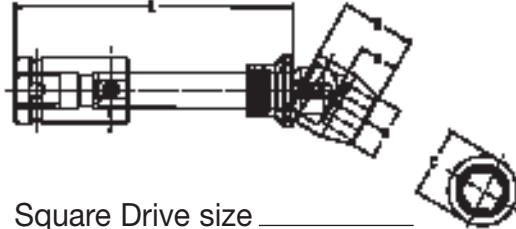

Square Drive size \_\_\_\_\_

Male hex drive, standard type

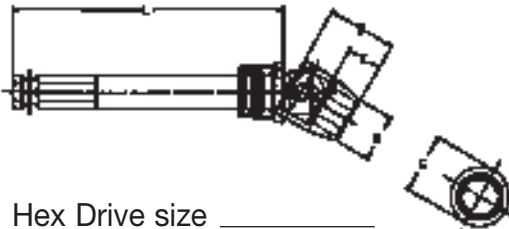

Hex Drive size \_\_\_\_\_

Male hex drive, tension type

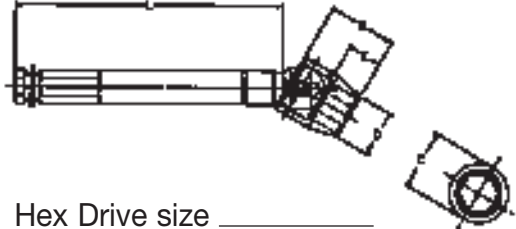

Hex Drive size \_\_\_\_\_

Female square drive, (short)

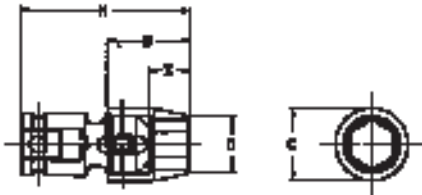

Square Drive size \_\_\_\_\_

B. Socket length \_\_\_\_\_ C. Socket diameter\* \_\_\_\_\_

D. Socket nose dia. \_\_\_\_\_ G. Depth of Clearance \_\_\_\_\_

L. Shank length \_\_\_\_\_ M. Overall length \_\_\_\_\_

\*Standard diameters are 5/8", 3/4", 7/8", 1", 1 1/4", 1 1/2", 1 3/4", 2"

## BROACH OPENING STYLE & SIZE

Hex \_\_\_\_\_

Double Hex \_\_\_\_\_

Quantity \_\_\_\_\_

Male square \_\_\_\_\_

Pin lock  
 Ball lock \_\_\_\_\_  
 Hole

**APPLIED or DRIVING TORQUE** \_\_\_\_\_

**Additional Specifications** \_\_\_\_\_